



Winpak Lane, Inc.

998 S. Sierra Way, San Bernardino, CA 92408 USA Tel: 909.885.0715 Fax: 909.381.1934

Email: sales2@winpak.com

www.winpak.com

The Winpak WP-20 is a high-output vertical/form/fill/seal pouch machine. It uses the highly efficient Winpakage® system, resulting in more than a 10% reduction in packaging material usage. The WP-20 is a revolutionary pouch machine capable of producing up to 600 packages per minute.

Features include:

- Precision servo-drive system
- Accurately fills a wide variety of products
- Single film roll allows for front and rear package to be graphically registered for maximum exposure.
- Particulates up to 1/4" (7 mm)
- Product recipe feature for fast changeovers
- Product tank, valve, and piping options available
- CIP capable filling system available
- User friendly packaging features and options such as notches, perforations, pouring spouts, etc.
- Remote electrical troubleshooting capable
- Field-configurable optional controls

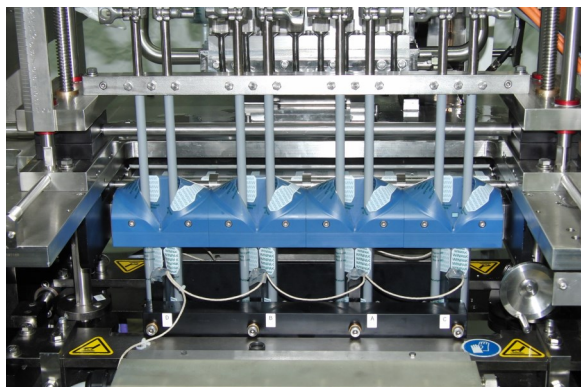

WP-20	
FILM WIDTH	Up to 21.6" (548.64 mm)
PACKAGES PER CYCLE	4 to 10
PACKAGE WIDTHS	Minimum 1" (25.4 mm) Maximum 2.66" (67.56 mm)
PACKAGE LENGTHS	Minimum 2" (50 mm) Maximum 9" (228 mm)
CYCLES PER MINUTE	15 to 75
FILL VOLUME RANGE	Minimum 0.1 fl. oz. (3 ml) Maximum 5 fl. oz. (142 ml)
FILL TEMPERATURE RANGE	Minimum 34°F (1°C) Maximum 195°F (90°C)

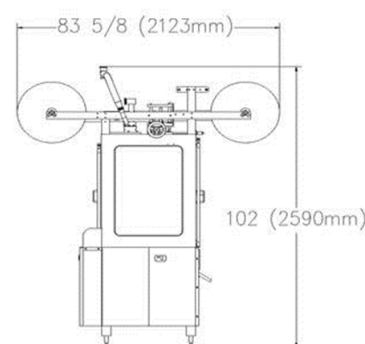
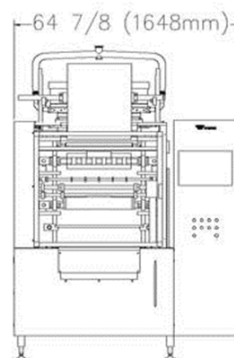
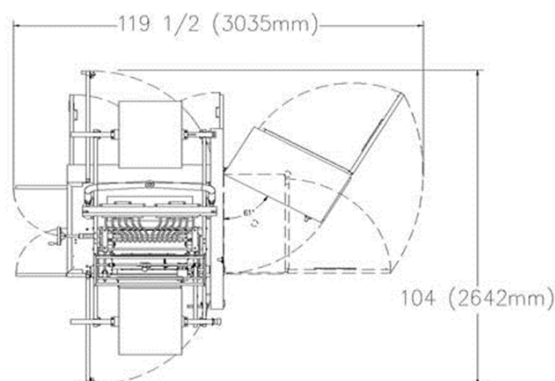

WP-20 options include:

- Convertible to 4 side seal (W-18)
- Splice detector
- Specialized low viscosity fillers
- Ink jet or thermal transfer date coding
- Package discharge gate



Winpak Lane, Inc.

998 S. Sierra Way, San Bernardino, CA 92408 USA Tel: 909.885.0715 Fax: 909.381.1934

Email: sales2@winpak.com

www.winpak.com